

Please Note:-  
1. Track Support beam must be level and straight  
**2. All openings must be Plumb.**  
**3. Floor must be made level to (+/-)5mm.**  
All this allows for maximum acoustic effect and operability.  
If any problem occurs in any of these areas, the operation of the door will be compromised

PRODUCT	400 Series
TYPE	402
TRACK TYPE	SS1
TRACK FINISH	TBC
CONFIGURATION	Paired Panels
CLOSURE	Expanding Edge
STC	41
WEIGHT	27kg/m²
Panel Finish	Autex Cube
Aluminium Finish	TBC

DRAWING APPROVAL

PLEASE CHECK THE APPROPRIATE BOXES  
SIGN AND PRINT NAME

FINISHES	
CRITICAL DIMENSIONS (Red)	
HEIGHT	
WIDTH	

SIGNED BY

PRINT NAME

DATE

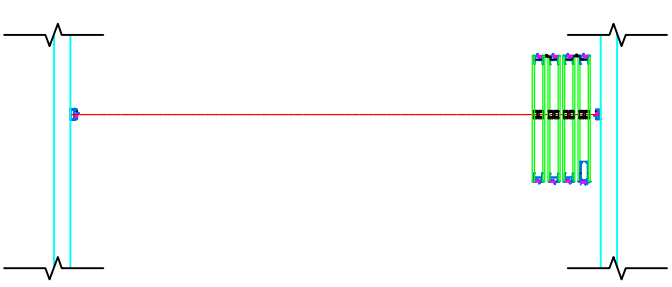
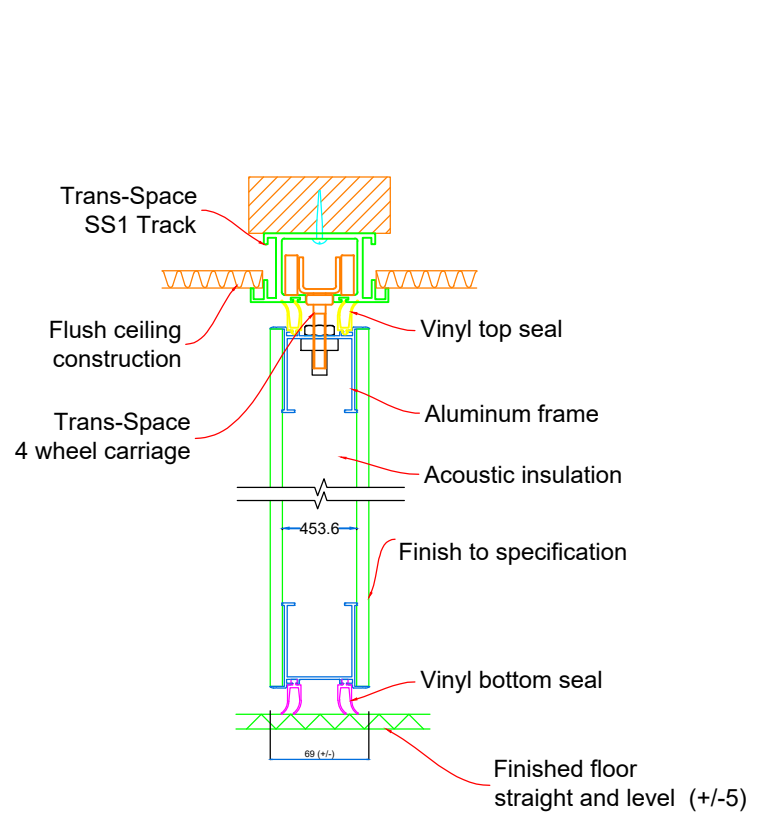
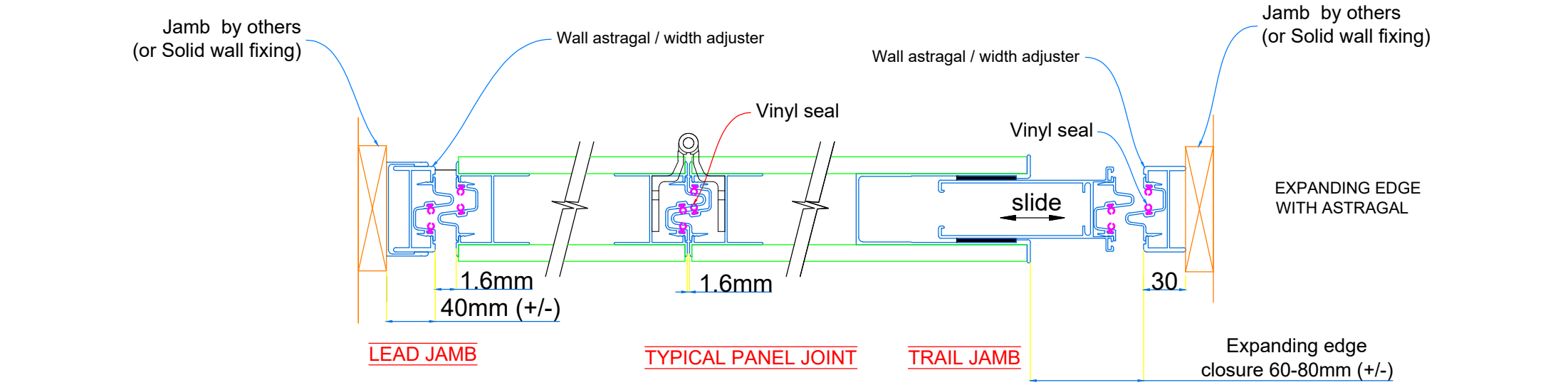

Doors in Stacked position

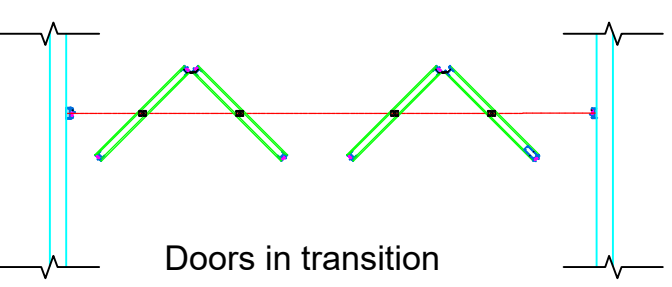

Doors in transition

Section A-A

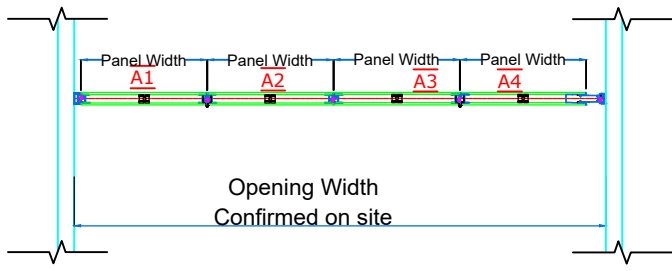

APPROVAL REQUIRED

